

GU

Designed in Germany
C59846000 | 08 | 06.2021
23589S

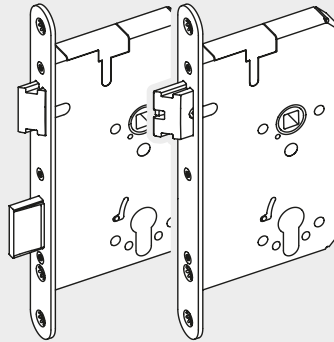

TÜRTECHNIK | DOOR TECHNOLOGY



B-21xxx | B-23xxx | B-217xx
B-218xx | B 2190 | B 239x

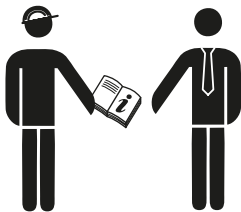

C59646000!

Vorsprung mit System
Securing technology for you





1. B-23xxx

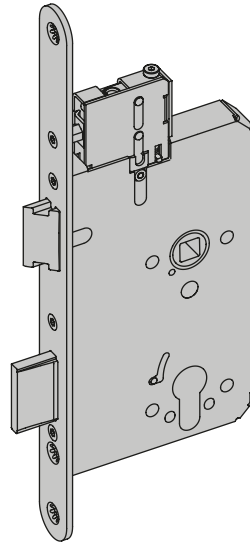
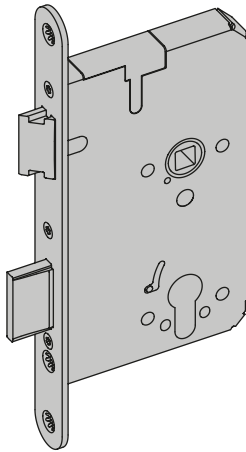
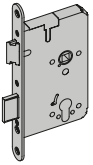

2. B-21xxx

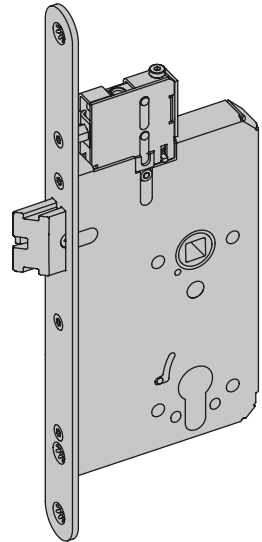
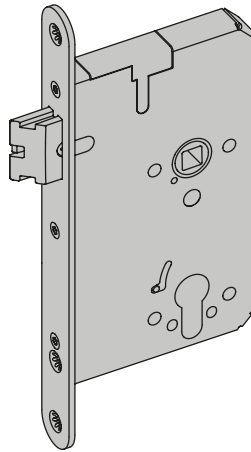
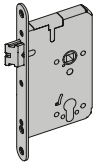



3.

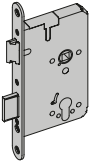

1.

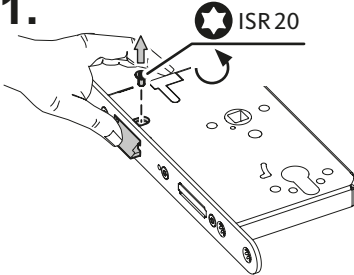

2.

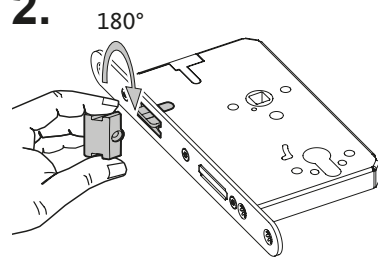

3.

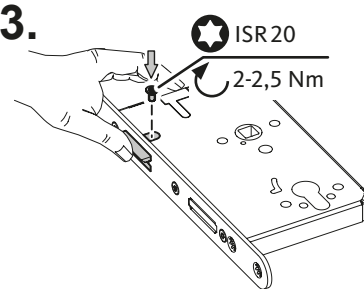

4.

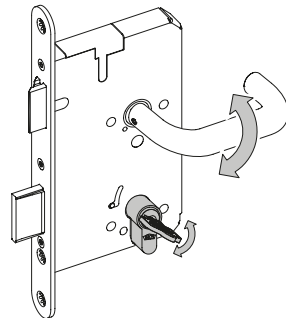

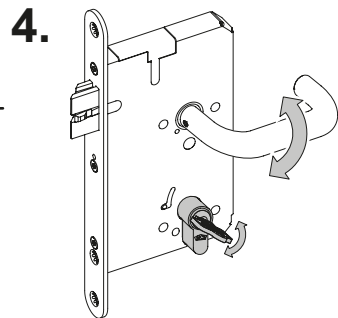
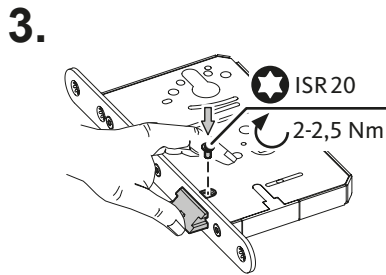
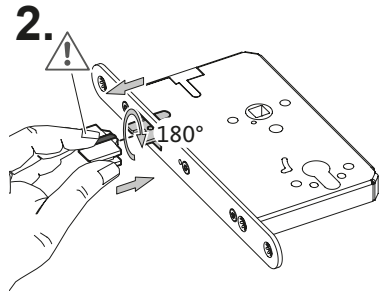
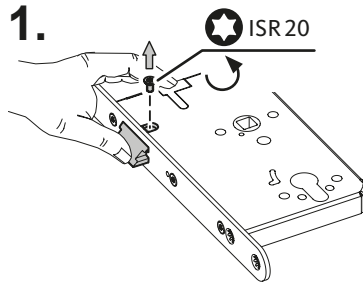
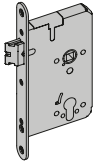



4.

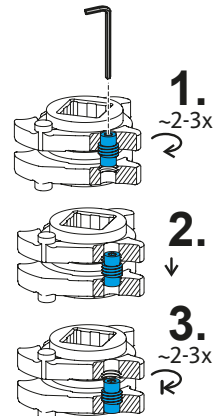
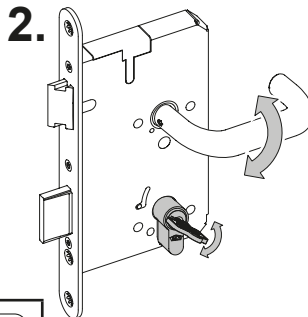
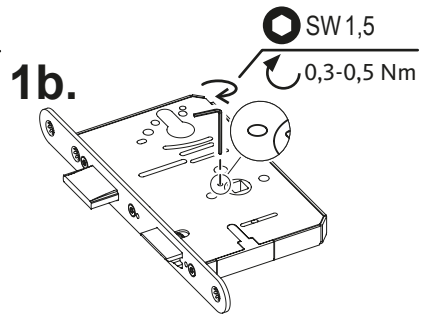
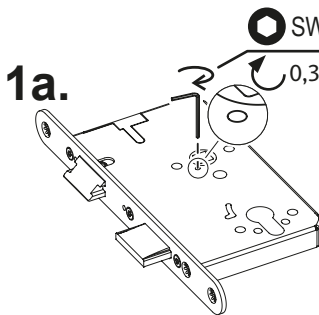
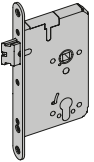
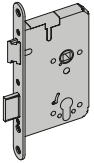
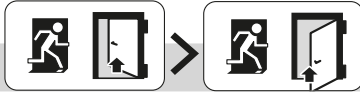

5.

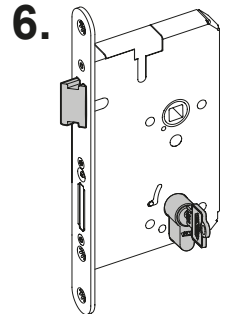
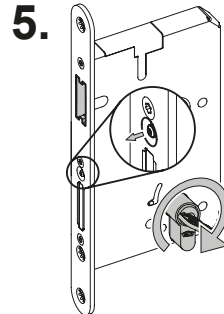
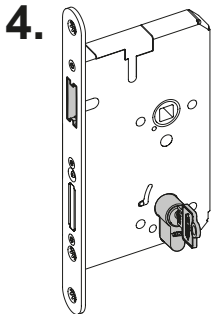
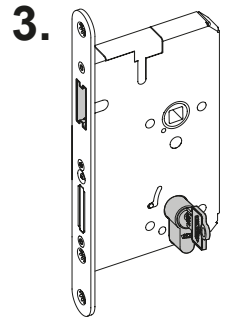
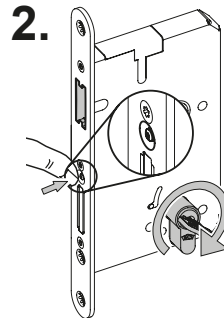
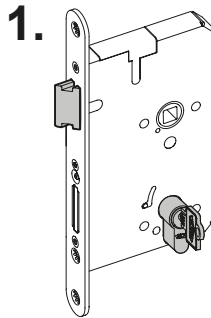
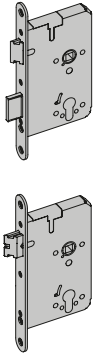



6.



DIN VDE 0100, DIN VDE 0160, DIN VDE 0632

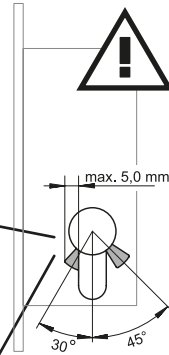
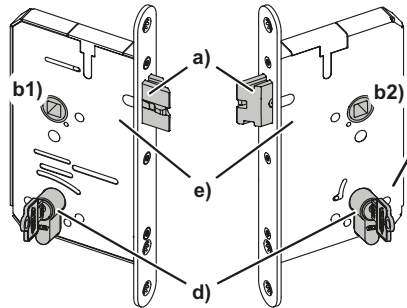
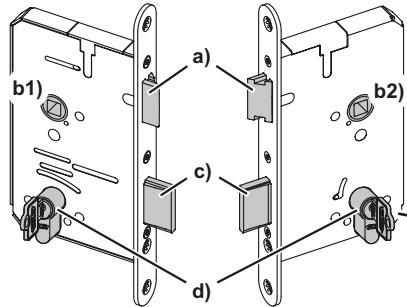
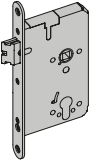

IP30

°C +60°C
-20°C

≤95%
40°C

EN III
50131-1

EN III
1670 (96h)

P_{max} 1W
I_{max} 100mA DC
U_{max} 30V DC
(9V/100mA;
12V/80mA;
24V/40mA;
30V/30mA)

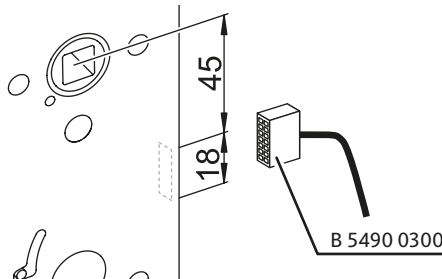

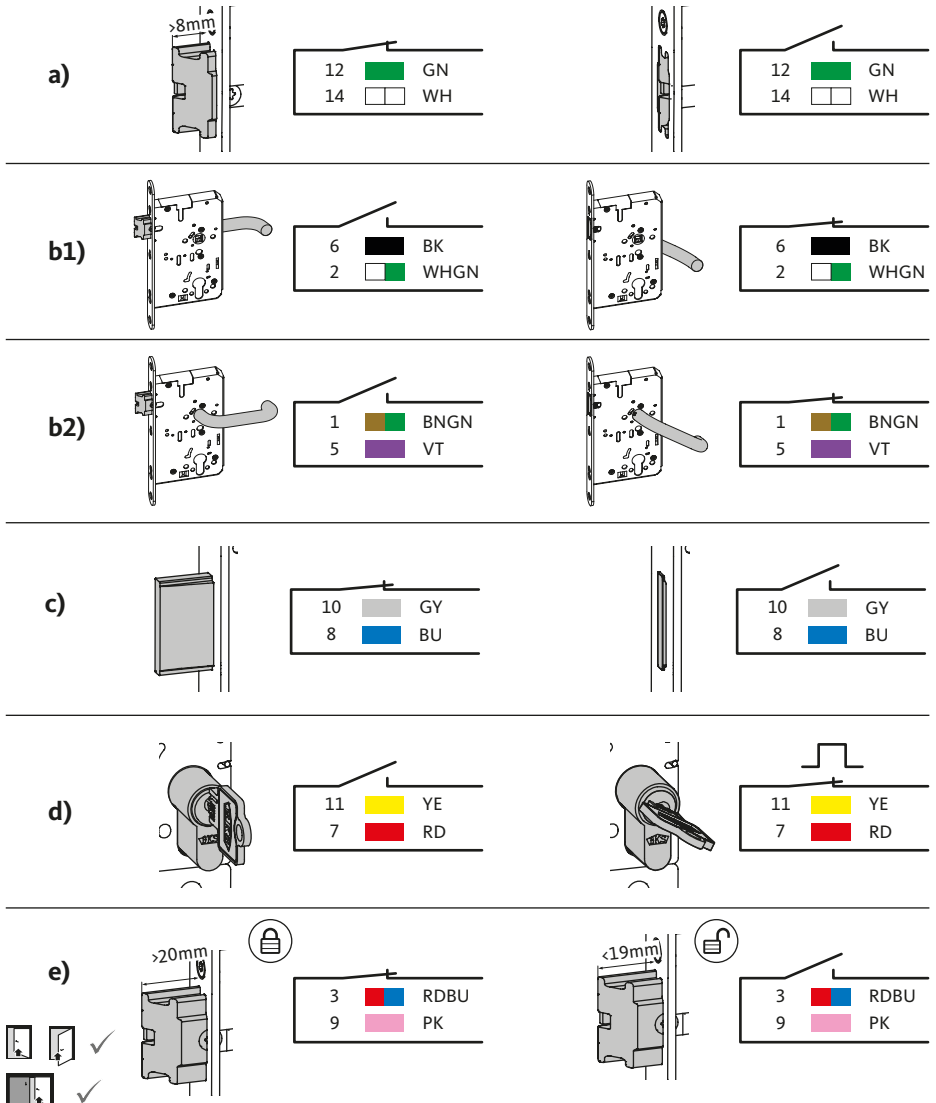



7. B-217xx | B-218xx

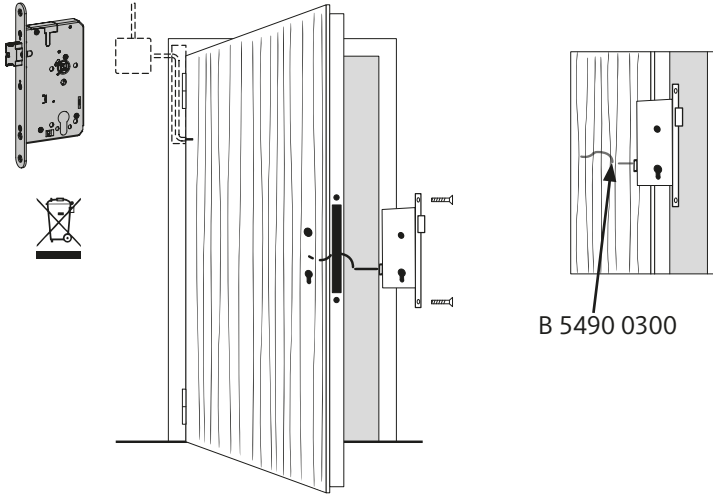

U_{max} 12-24 V DC \pm 15% \approx 100 mVpp
 I_{max} 250 mA
 I_{min} 20 mA
 ED 100%

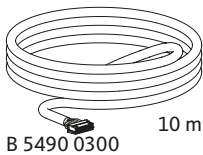
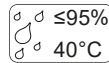
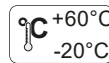

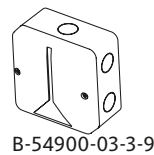

 option

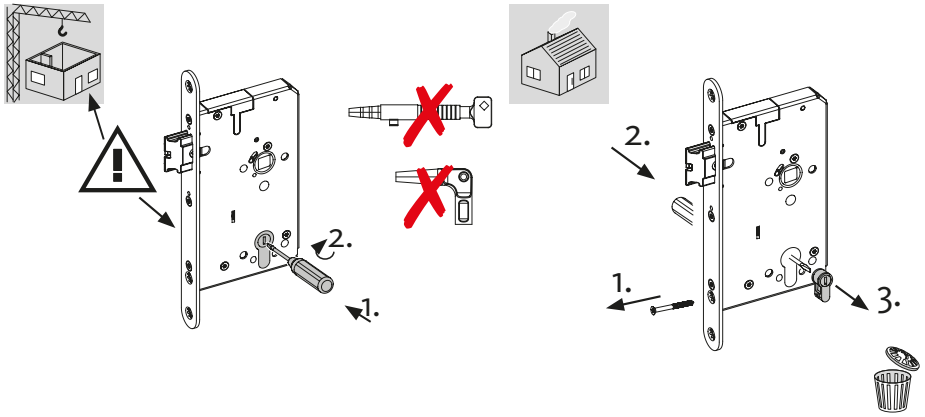

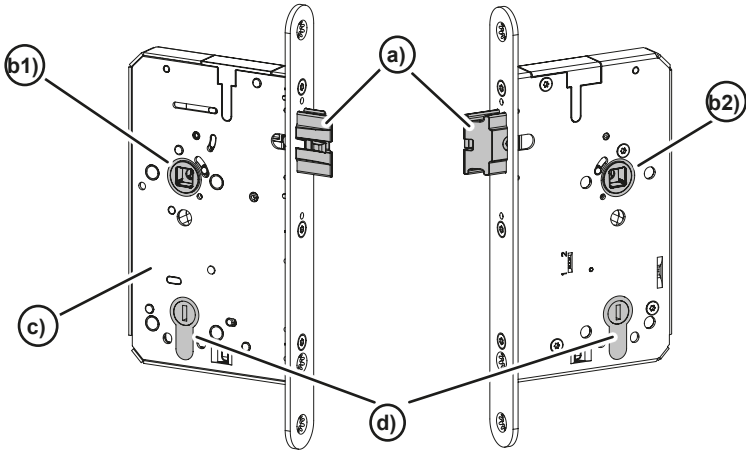

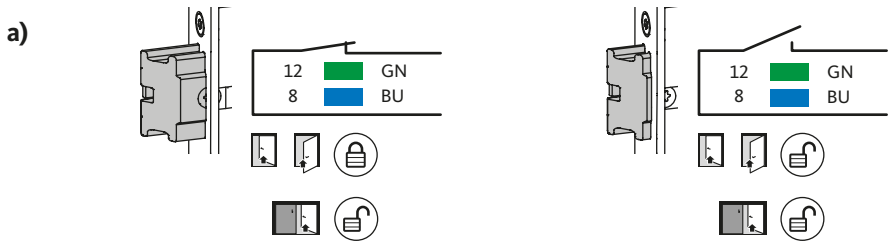
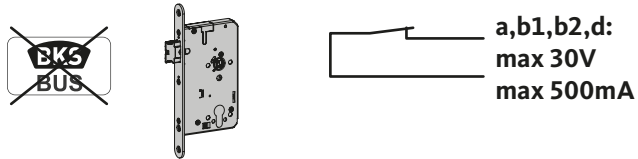

<p>BKS BUS option</p>				
<p>BKS BUS</p>	<p>B-2170xx B-2171xx B-2175xx B-2180xx B-2181xx B-2185xx</p>	<p>B-54900-03-3-9</p>	<p>B-55600-10-4-6 B-55600-13-4-6</p>	<p>B-55600-20-1-8 B-55600-20-4-8 B-55600-23-1-8 B-55600-23-4-8 B-55600-25-4-8</p>
<p>RS-485 A</p>		<p>LA</p>		
<p>RS-485 B</p>		<p>LB</p>		
<p>+12...24 V DC</p>		<p>V1</p>		
<p>GND</p>		<p>G1</p>		



+12 - +24 V DC 13 BN
GND 14 WH

IEC 60757

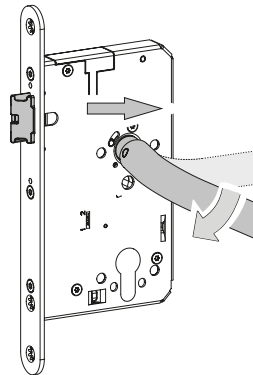
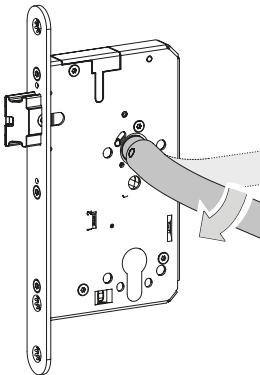
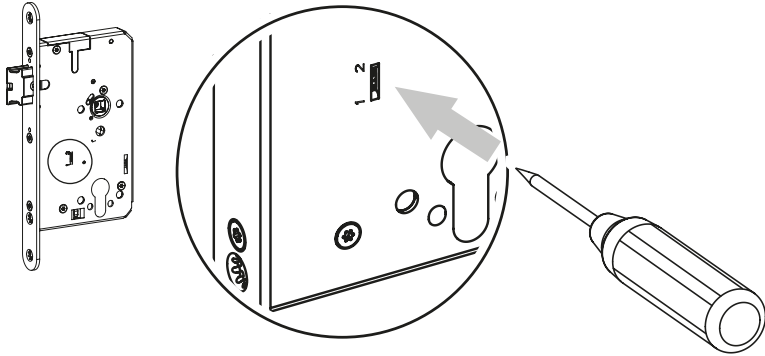

8.

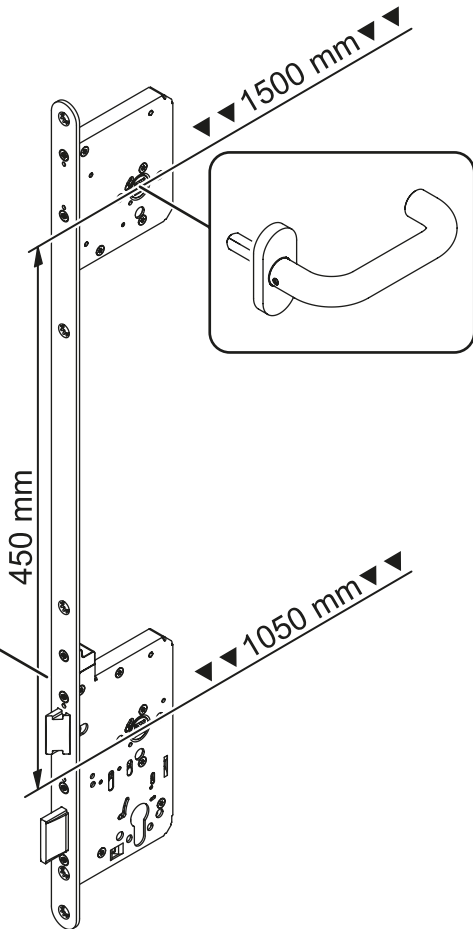
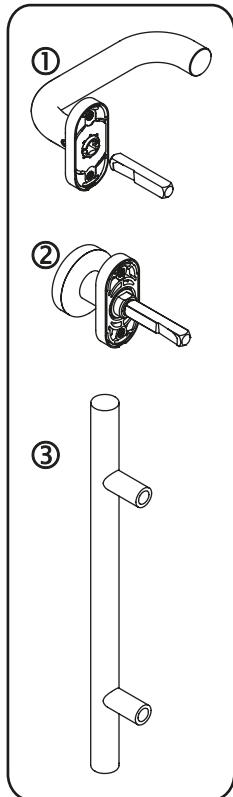
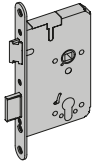
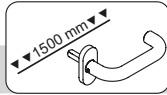



9.

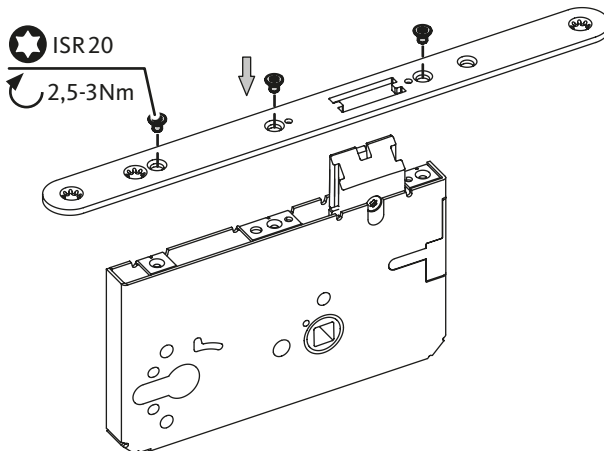
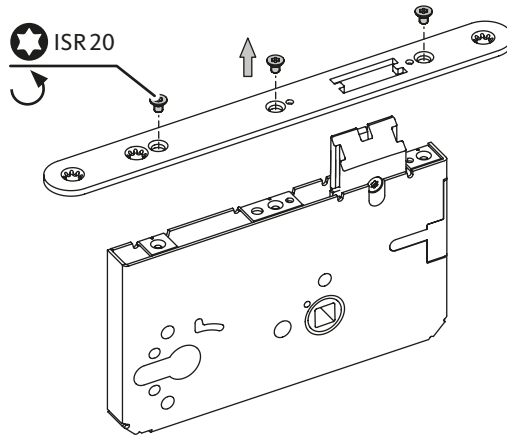
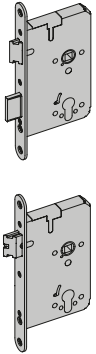
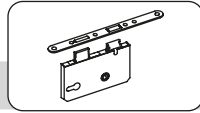

10. B-21xxx/B-23xxx + B 1795

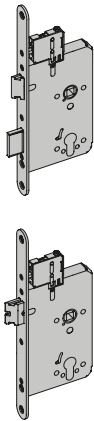

SW7

1,5-2 Nm

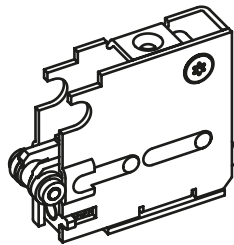

D55



D60

5 mm



D65

10 mm

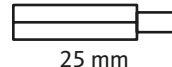

D80

25 mm

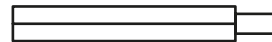

D100

45 mm

ISR20

2,5-3 Nm

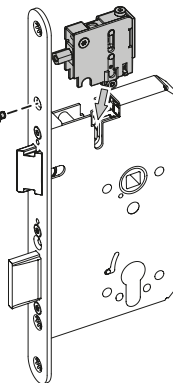

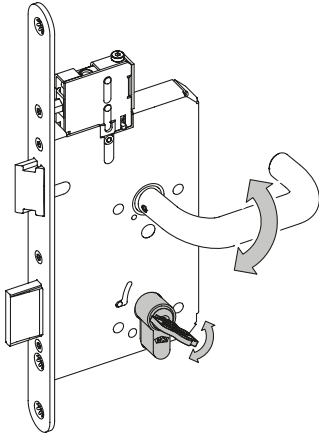

SW 2,5

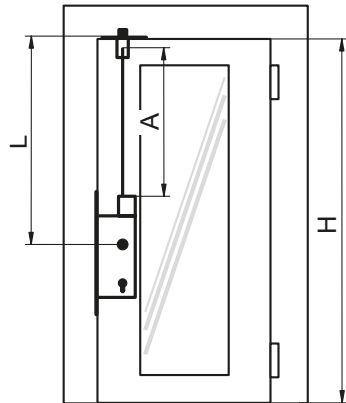
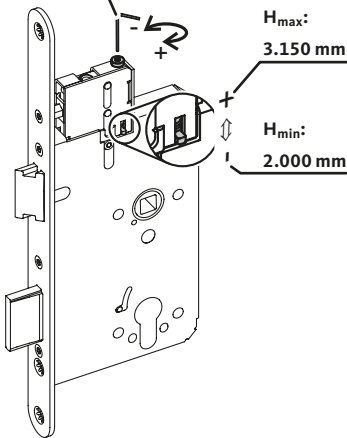

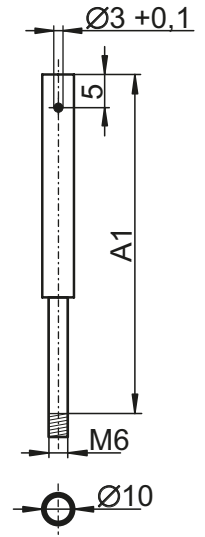
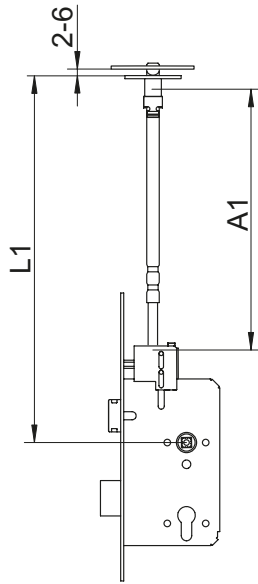

$A1 = L1 - 98 \text{ mm}$

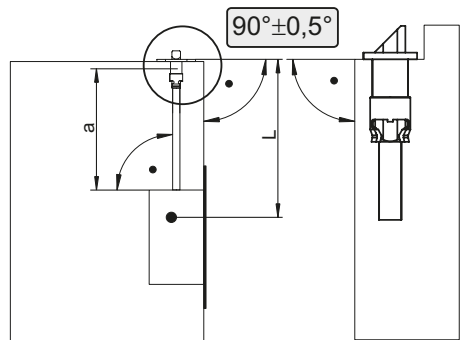
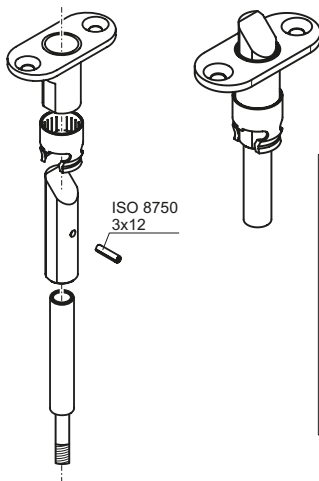

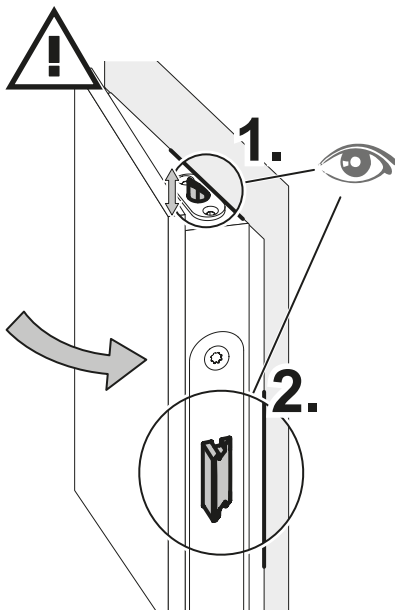
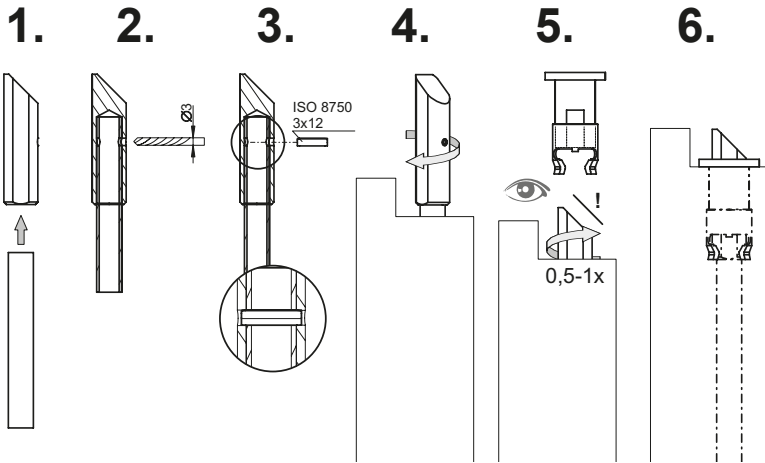

11.



+

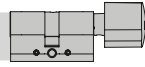

/

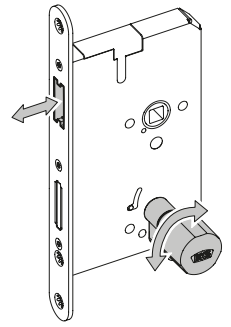
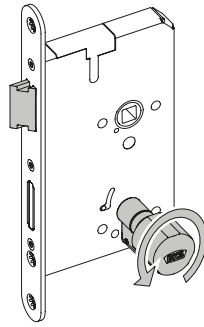
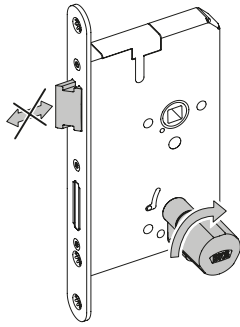
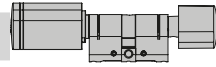

12.

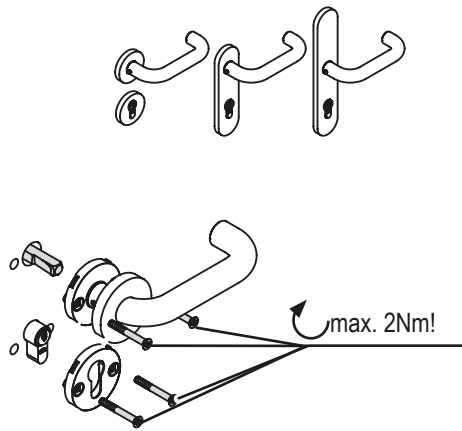
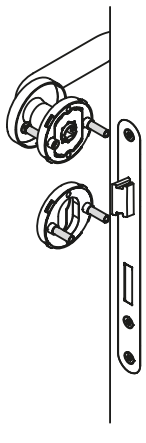



13. B 2390

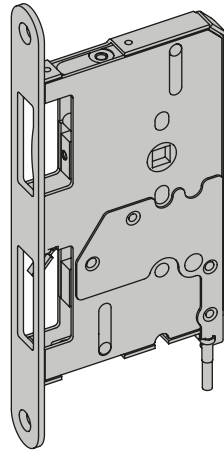
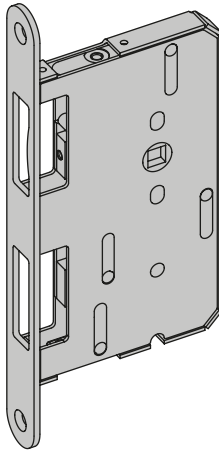
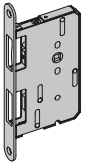

14. B 2190

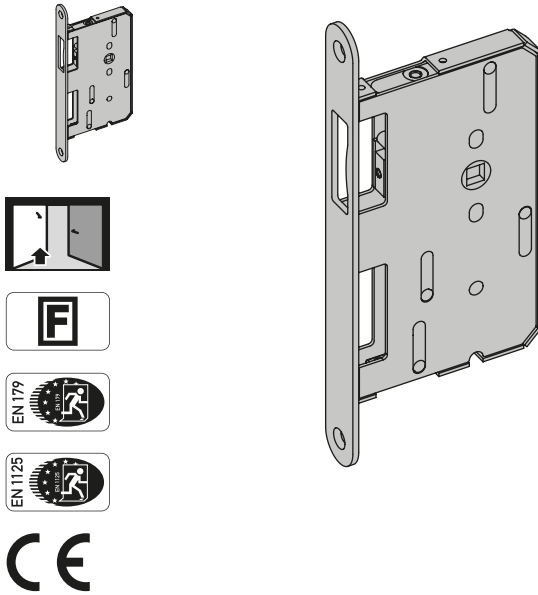



15. B 2495

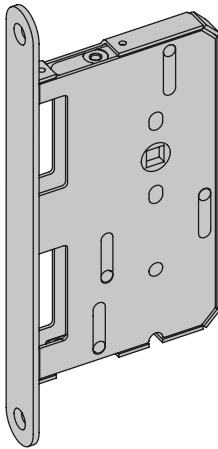
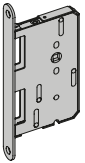

16. B 2390



DIN VDE 0100, DIN VDE 0160, DIN VDE 0632

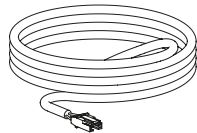
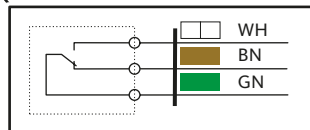
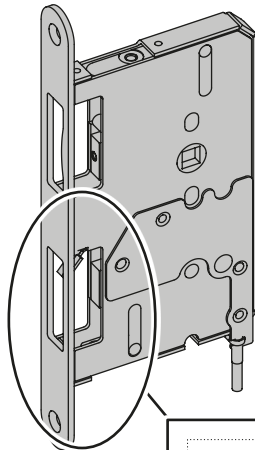

B 5490 010X



17. B 2X9X + B 1895 (+ B 2598)

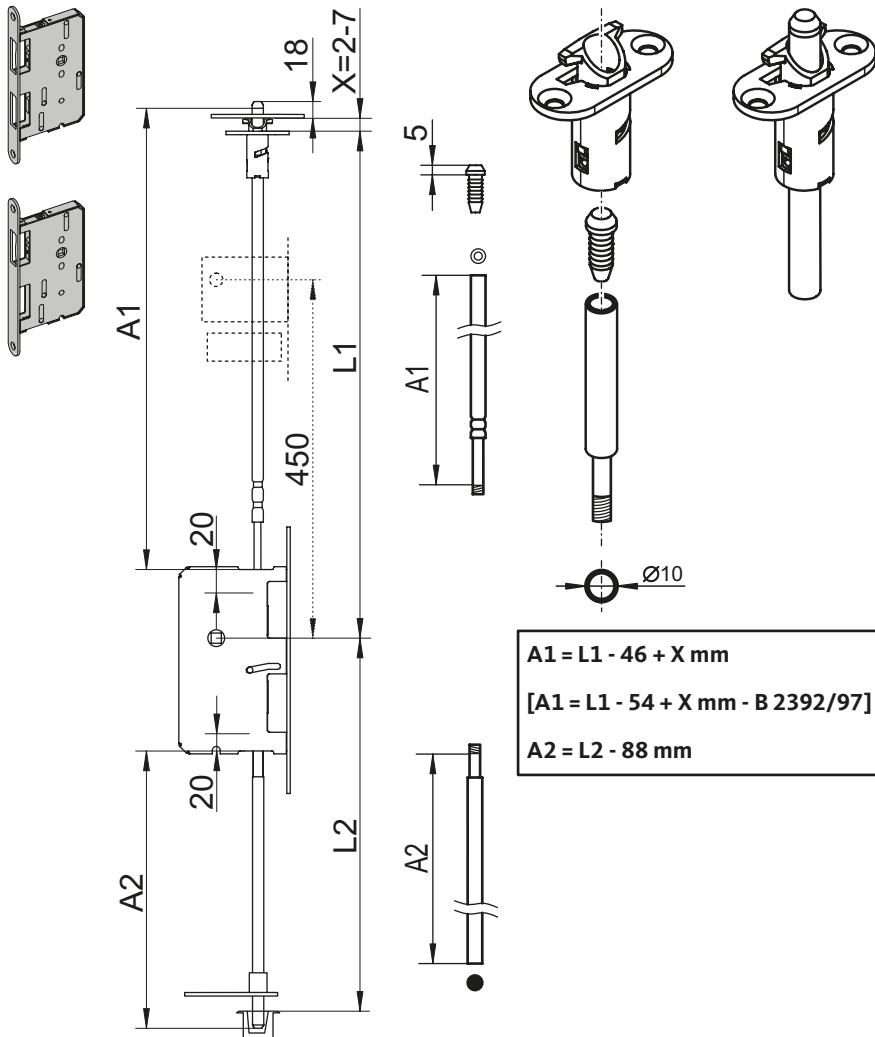

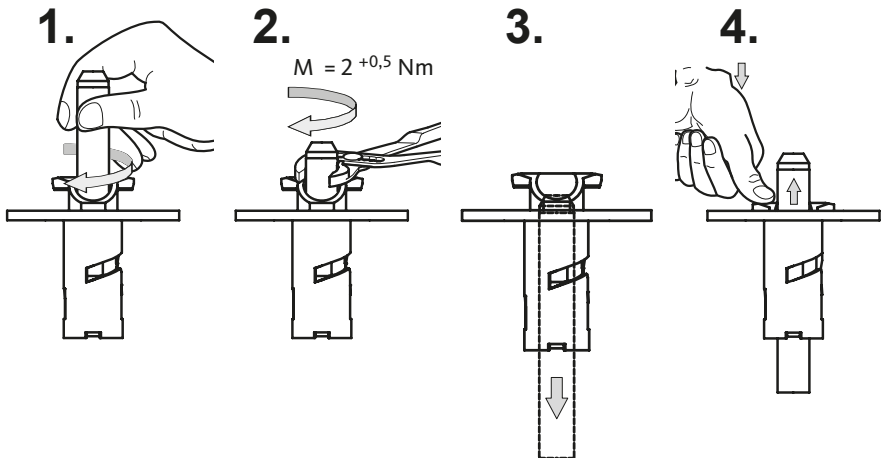
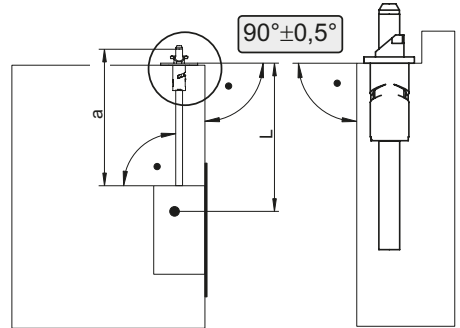
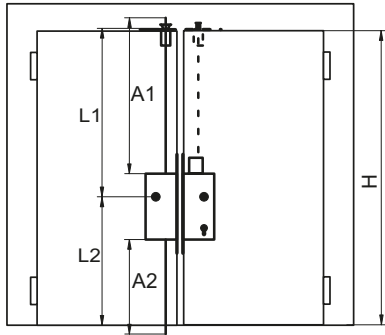



18. B 2X9X + B 1796

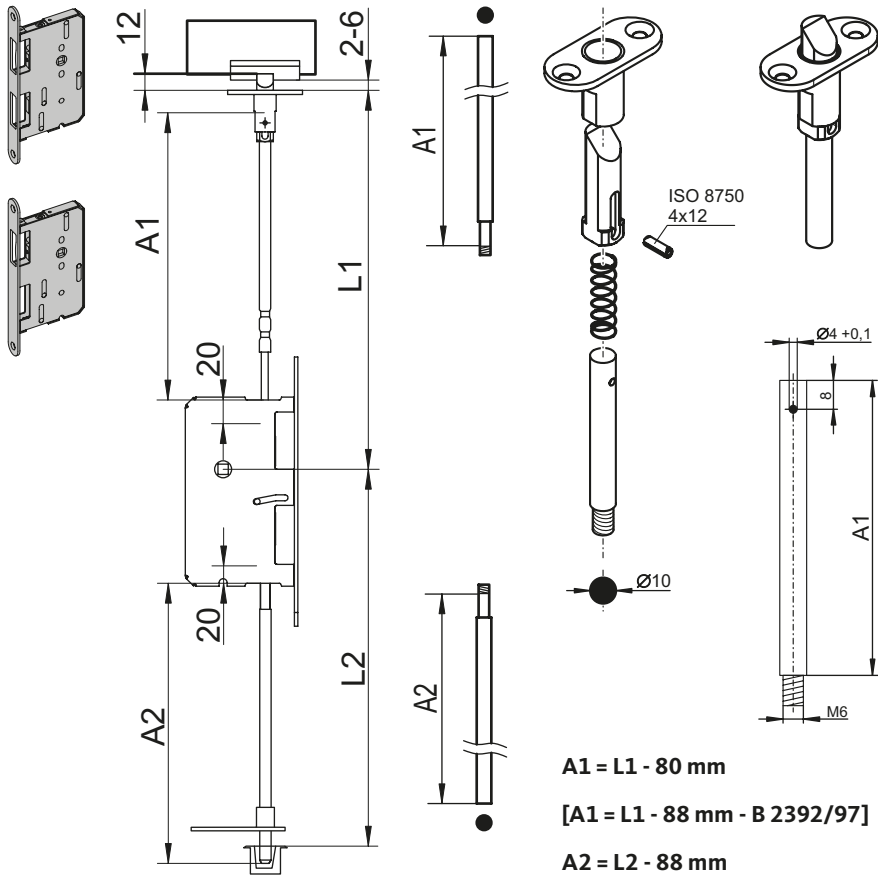

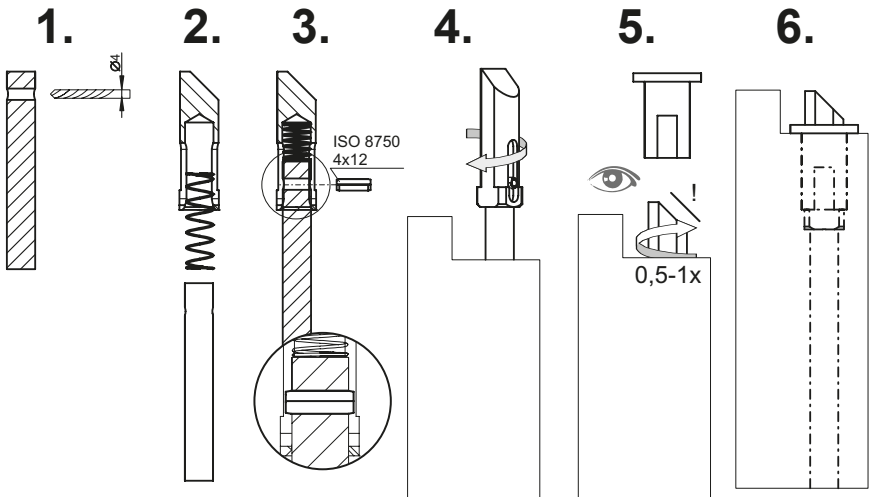
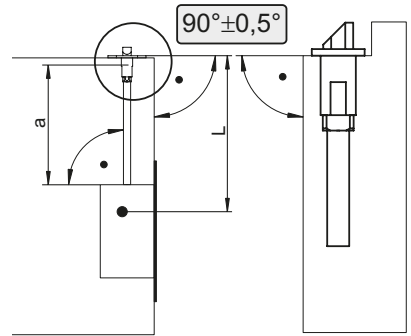
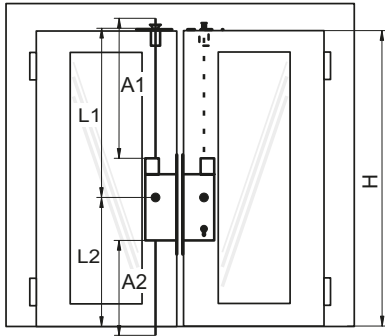



19. B-232xx

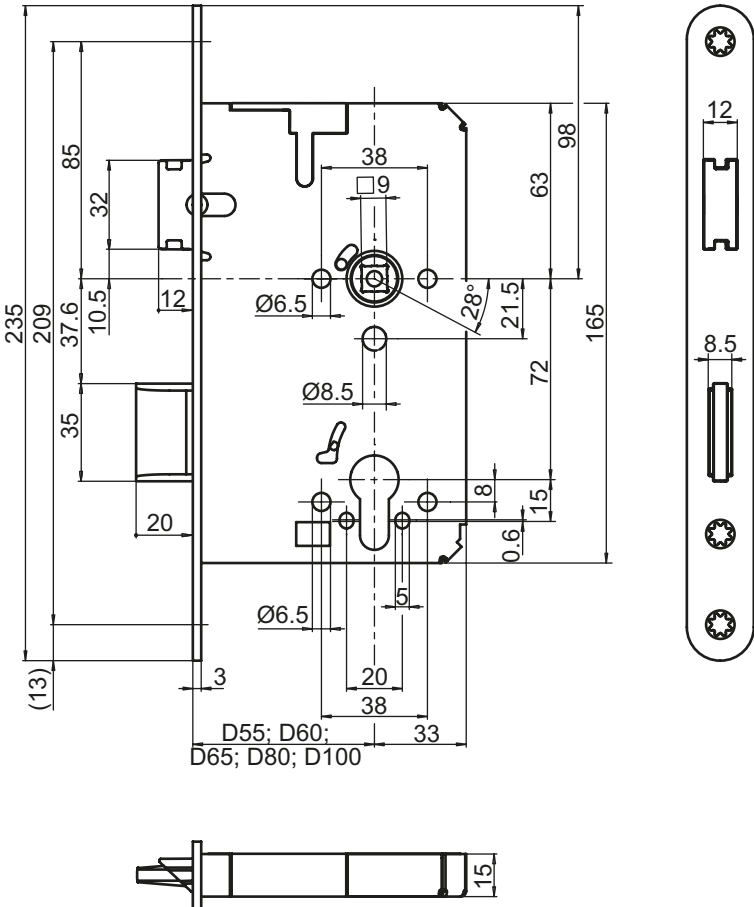



23. B 2390

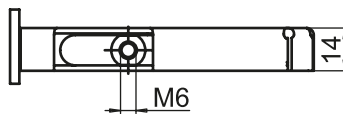
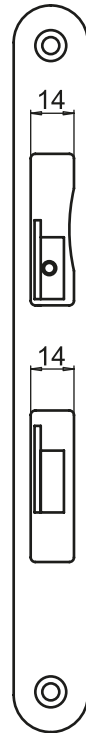
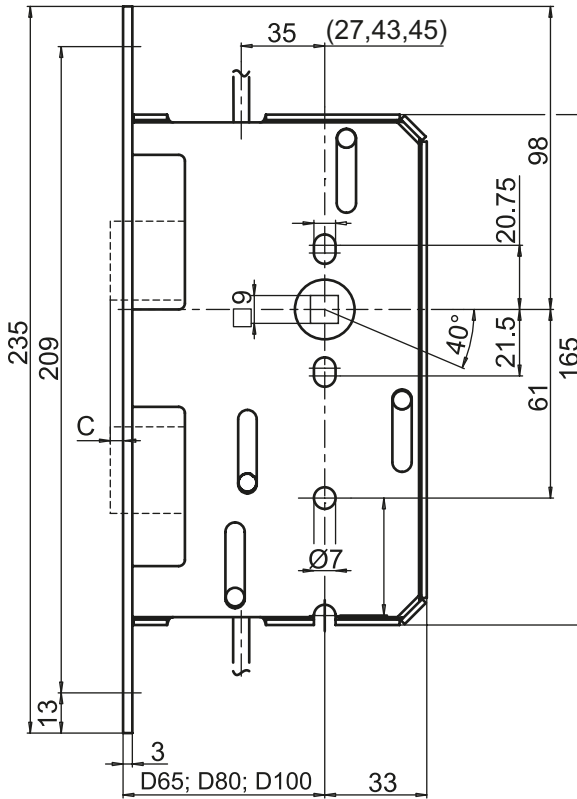
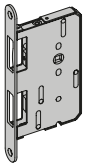

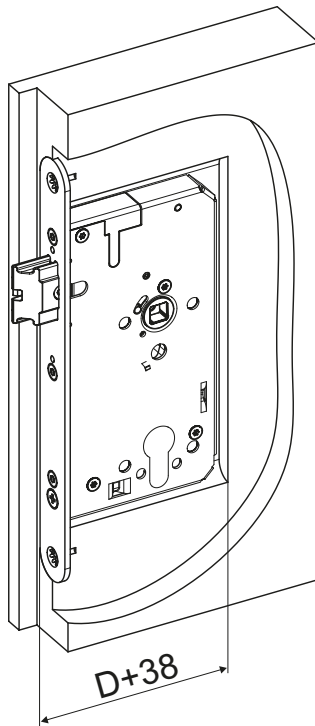
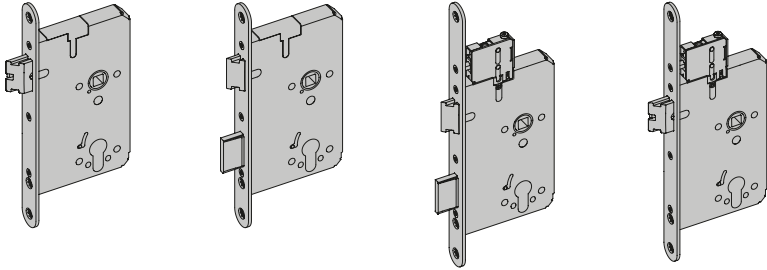

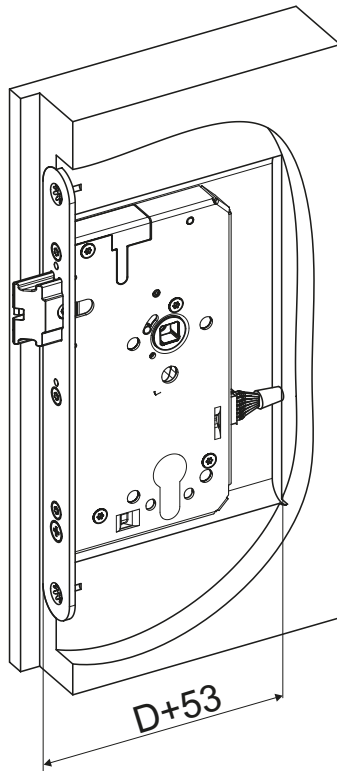
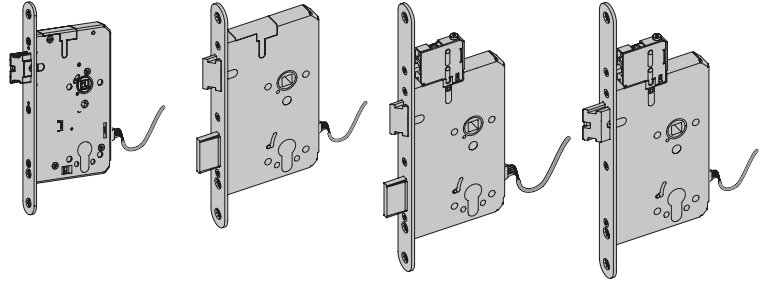

B-21xxx | B-23xxx | B-217xx | B-218xx | B 2190 | B 239x

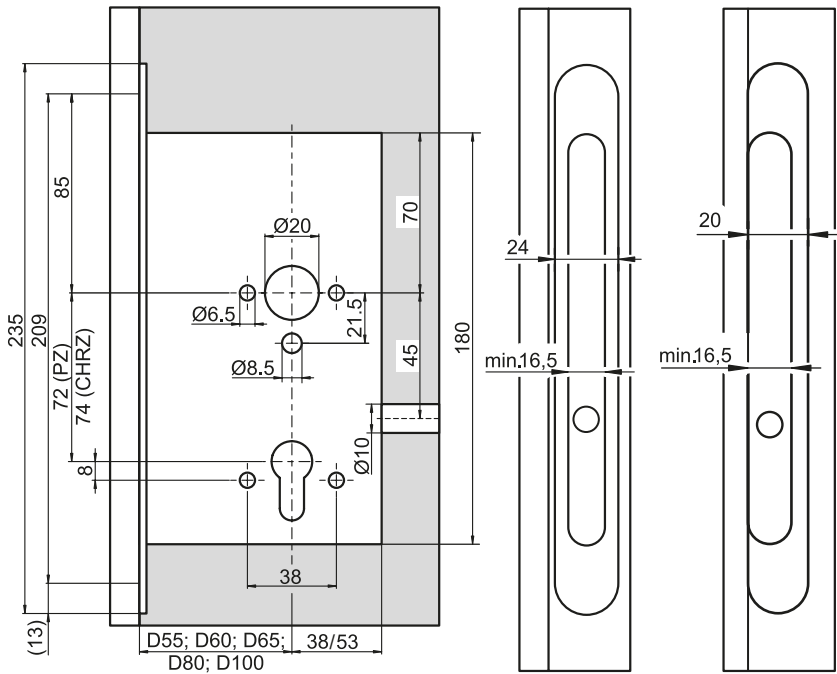
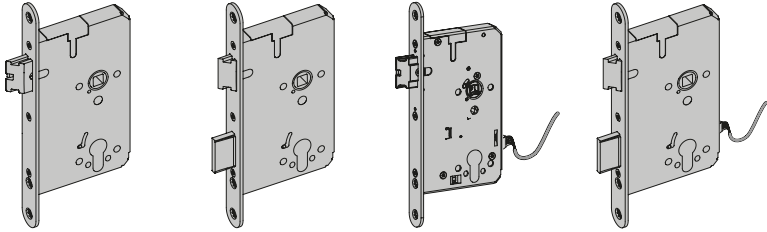

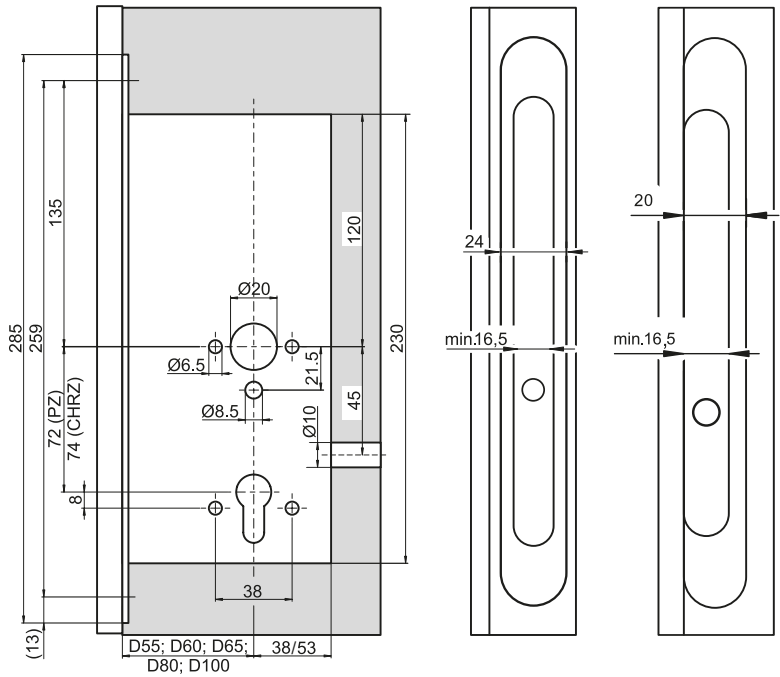
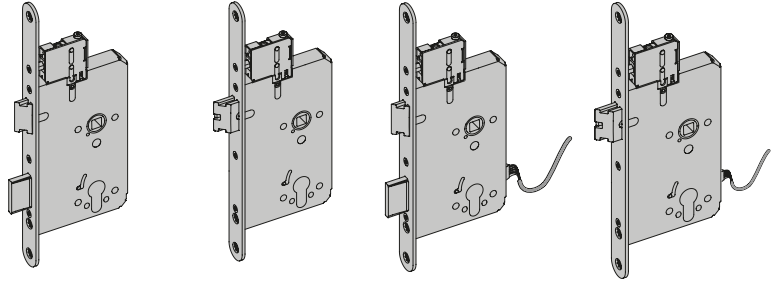

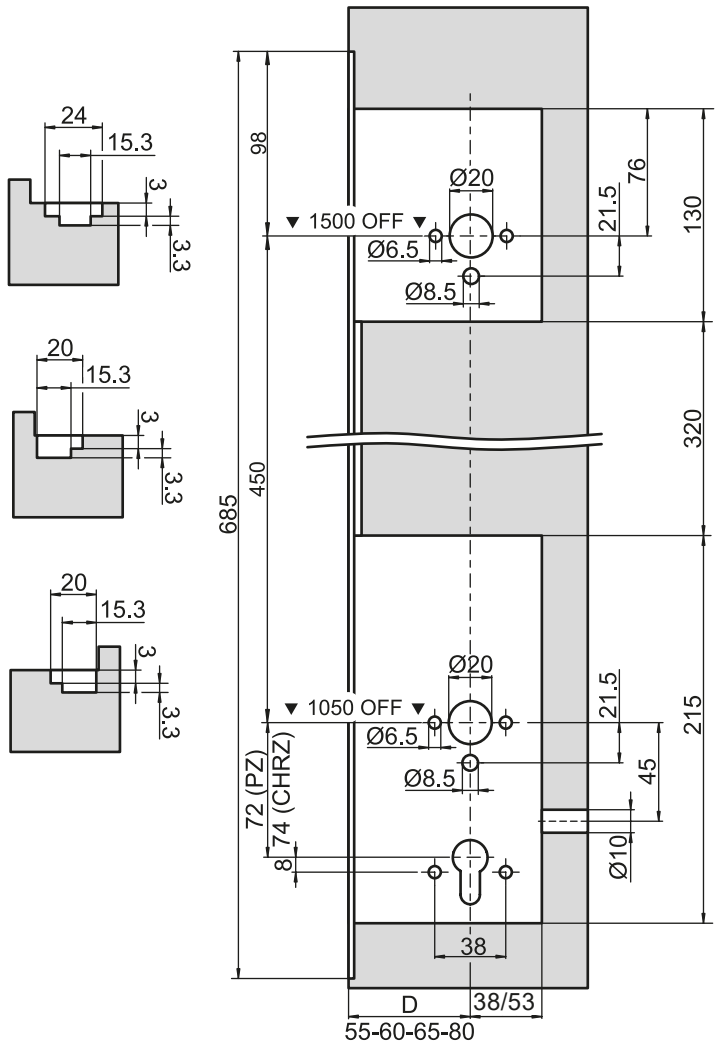



26. B-9000x

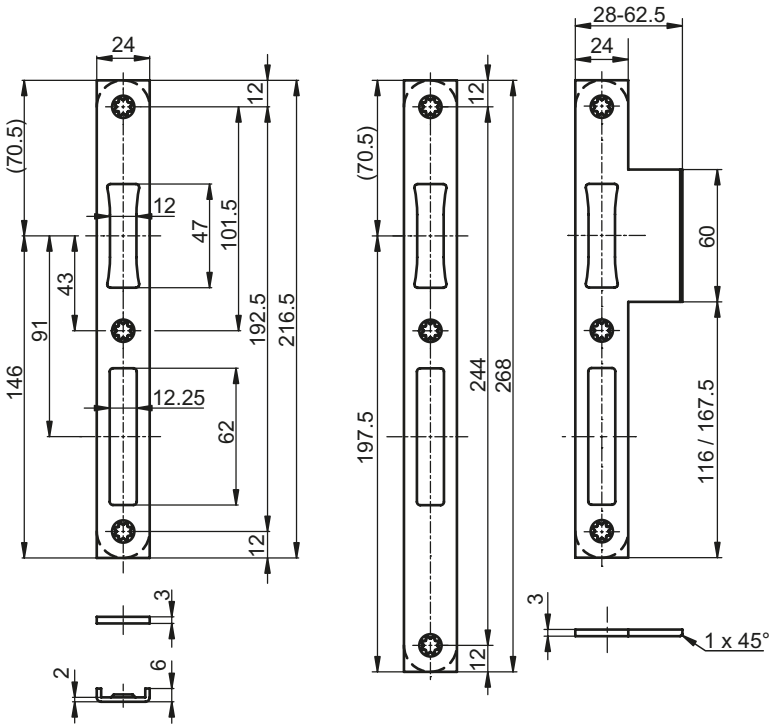

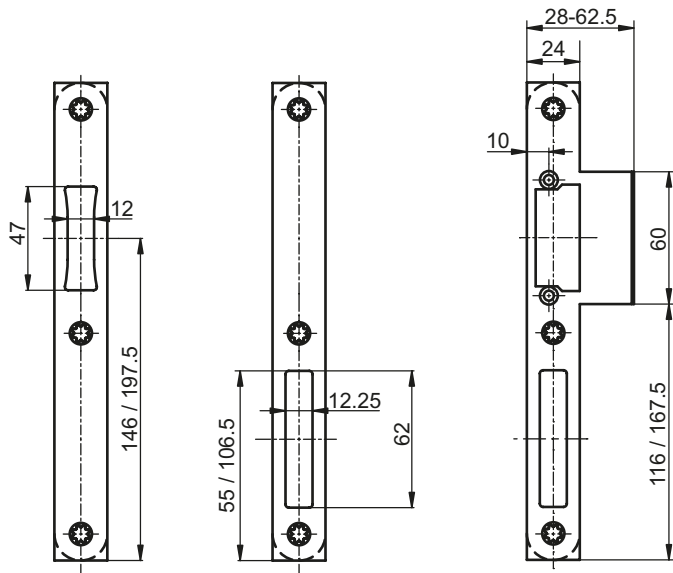



Herausgeber | Editor:

BKS GmbH

Heidestr. 71

D-42549 Velbert

Tel. + 49 (0) 20 51 2 01-0

Fax + 49 (0) 20 51 2 01-97 33

www.g-u.com

Fehler, Irrtümer und technische Änderungen vorbehalten.
Errors and omissions reserved. Subject to technical modifications.
Sous réserve d'erreurs et de modifications techniques.
Reservado el derecho a realizar modificaciones técnicas. Salvo error u omisión.